

# C256



**Challenger**

2026

More info about this vehicle

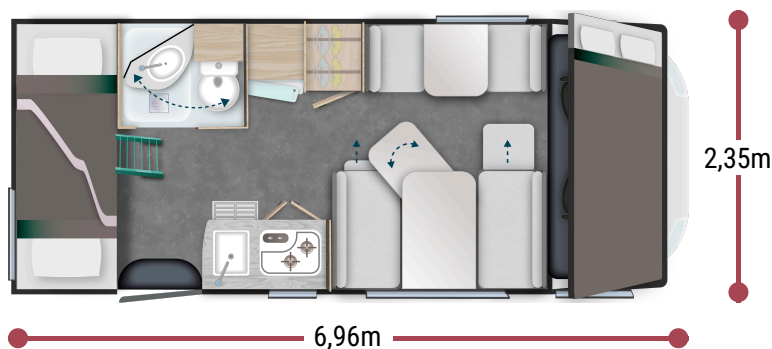

3,06 m  
2,05 m



7



7



7



2910/3500



132x147/167  
+ 147x60  
155x203  
211x80  
211x80



2.2L 140 HP / 103 kW /  
Manual



5500 W diesel **BREAK**  
gas water heater **BREAK**



150L

## STRONG POINTS

### OVERCAB 7 SEATS

### LOW REAR FOLD-DOWN BUNK BED TO ENLARGE GARAGE

### PULL-DOWN OVERCAB BED BASE

## BREAK EDITION



**FIAT**

- White chassis
- Manual cab air conditioning
- Driver and passenger airbag
- Fix and go
- Swivel seats in the cab, with double armrests and adjustable height
- Cab seat covers with matching cushions
- Electric de-icing rearview mirrors
- Cruise control and speed limiter
- ESP
- Traction +
- Hill descent control
- Eco pack: Stop&Start, smart alternator, electronically-controlled fuel pump
- Unit step insulation
- Panoramic skylight (or two skylights)
- Separation curtain cab/cell

#### PACKS

- Pack Connect : Bluetooth radio DAB with touchscreen and steering wheel controls and reversing camera

- Double-locking windows with combined blinds/screens
- Interior cab isothermal shutters
- Damped cupboard hinges
- USB ports/USB-C
- Technibox
- 15" steel rims with grey trims
- All-season tyres
- TV-ready
- Heating using vehicle fuel used while on the road
- Entrance door exterior lighting
- Wardrobe
- Solar panel ready (MPPT ready)
- Rear camera pre-wiring
- Conception IRP : toit plancher parois polyester, plancher 64 mm

- Pack Arctic: Insulated and heated waste water tank, fridge vent cover, thermal external blinds, enhanced heating, electric boiler\*, heated floor